



# Operating Instructions

Translation of original operating instructions

**Hydraulic Manhole Cover Lifter SDH-H**

**SDH-H-15**



Bitte beachten Sie, dass das Produkt ohne vorliegende Betriebsanleitung in Landessprache nicht eingesetzt / in Betrieb gesetzt werden darf. Sollten Sie mit der Lieferung des Produkts keine Betriebsanleitung in Ihrer Landessprache erhalten haben, kontaktieren Sie uns bitte. In Länder der EU / EFTA senden wir Ihnen diese kostenlos nach. Für Länder außerhalb der EU / EFTA erstellen wir Ihnen gerne ein Angebot für eine Betriebsanleitung in Landessprache, falls die Übersetzung nicht durch den Händler/Importeur organisiert werden kann.

Please note that the product may not be used / put into operation without these operating instructions in the national language. If you did not receive operating instructions in your national language with the delivery of the product, please contact us. In countries of the EU / EFTA we will send them to you free of charge. For countries outside the EU / EFTA, we will be pleased to provide you with an offer for an operating manual in the national language if the translation cannot be organised by the dealer/importer.

Contents

1

EC-Declaration of Conformity .....

3

2

Safety .....

4

2.1

Safety symbols .....

4

2.2

Safety Marking.....

4

2.3

Definition skilled worker / specialist .....

4

2.4

Personal safety requirements .....

5

2.5

Protective equipment.....

5

2.6

Accident prevention .....

5

2.7

Function Control .....

5

2.7.1

General .....

5

3

General.....

6

3.1

Authorized use.....

6

3.2

Survey and construction .....

7

3.3

Technical Data.....

7

3.4

Accessories .....

8

4

Operation .....

9

4.1

Attaching Variants .....

9

4.2

Device Operating .....

11

5

Maintenance and care .....

13

5.1

Maintenance .....

13

5.1.1

Mechanical .....

13

5.2

Repairs .....

13

5.3

Safety procedures .....

14

5.4

Hints to the type plate.....

15

5.5

Hints to the renting/leasing of PROBST devices .....

15

## EC-Declaration of Conformity / UKCA-Declaration of Conformity

Manufacturer: Probst GmbH  
Gottlieb-Daimler-Straße 6  
71729 Erdmannhausen, Germany  
info@probst-handling.de  
www.probst-handling.com



Importer: Probst Ltd  
Unit 2 Fletcher House  
Stafford Park 17  
Telford Shropshire TF3 3DG, United Kingdom  
www.probst-handling.co.uk  
sales@probst-handling.co.uk



The machine described above complies with the relevant requirements of the following EU directives:  
*The object of the declaration described above is in conformity with the relevant UK-Regulations and UK-Guidelines:*

**EC-machinery directive 2006/42/EC** (Reference: OJ L 157, 09.06.2006)

UK-Regulation: Supply of Machinery (Safety) Regulations 2008 (SI 2008 No. 1597)

The following standards and technical specifications were used:

### **DIN EN ISO 12100**

Safety of machinery - General principles for design - Risk assessment and risk reduction

UK-Regulation: BS EN ISO 12100-1:2003+A1:2009

### **DIN EN ISO 13857**

Safety of machinery - safety distances to prevent hazard zones being reached by upper and lower limbs.

UK-Regulation: BS EN ISO 13857:2019

### **Authorized person for EC-documentation:**

Name: Jean Holderied

Address: Probst GmbH; Gottlieb-Daimler-Straße 6; 71729 Erdmannhausen, Germany

### **Authorized person for UK-documentation:**

Name: Nigel Hughes

Address: Probst Ltd ; Unit 2 Fletcher House; Stafford Park 17; Telford Shropshire TF3 3DG, United Kingdom

Signature, information to the subscriber:

Erdmannhausen, 02.08.2021.....  
(Eric Wilhelm, Managing director)

## 2 Safety

### 2.1 Safety symbols



#### **Danger to life!**

Identifies imminent hazard. If you do not avoid the hazard, death or severe injury will result.



#### **Hazardous situation!**

Identifies a potentially hazardous situation. If you do not avoid the situation, injury or damage to property can result.



#### **Prohibition!**

Identifies imminent a prohibition. If you do not avoid the prohibition, death and severe injury, or damage to property will result.



Important informations or useful tips for use.

### 2.2 Safety Marking

#### WARNING SIGN

Symbol	Meaning	Order-No.:	Size:
	Danger of squeezing the hands.	2904.0221	30 mm
		2904.0220	50 mm
		2904.0107	80 mm

#### REGULATORY SIGN

Symbol	Meaning	Order-No.:	Size:
	Each operator must have read and understood the operating instructions (and all safety instructions).	2904.0665	30 mm
		2904.0666	50 mm

### 2.3 Definition skilled worker / specialist

Only skilled workers or specialists are allowed to carry out the installation-, maintenance-, and repair work on this device!

Skilled workers or specialists must have for the following points (if it applies for this device), the necessary professional knowledge.

- for mechanic
- for hydraulics
- for pneumatics
- for electrics

## 2.4 Personal safety requirements



Each operator must have read and understood the operating instructions (and all safety instructions). Only qualified, authorized personal is allowed to operate the device and all devices which are connected (lifting device/carrier).



The manual guiding is only allowed for devices with handles.

## 2.5 Protective equipment

The protective equipment must consist, according to the safety regulations of the following parts:

- Protective clothing
- Safety gloves
- Safety shoes

## 2.6 Accident prevention



- The workplace has to be covered for unauthorized persons, especially children.
- Take care in case of thunderstorm!



- The workplace has to be sufficiently illuminated.
- Take care with handling wet, dirty and not solidified components.



- The working with the device in case of atmospheric editions under 3 °C (37,5 °F) is forbidden! Because the goods could be fall down caused by dampness or freezing.

## 2.7 Function Control

### 2.7.1 General



- Before using the device check the functions and the working condition.
- Maintenance and lubrication are only permitted when device is shut down!



- Do not use the device, until all faults which can cause safety hazards are removed.
- If there are any cracks, splits or damaged parts on any parts of the device, **immediately** stop using it.



- The operating instructions must be available at the workplace every time.
- Do not remove the type plate of the machine.
- Unrecognisable information signs (such as regulatory or prohibition signs) must be replaced.

### 3 General

#### 3.1 Authorized use

The device (SDH-H) is exclusively suitable to lift and move all common sizes of covers.

The pulling force of covers is enough up to maximally 1500 kg (3,300 lbs).

Various keys and spreader bars are accessories.



The pulling force of 1,500 kg (3,300 lbs) of the device (SDH-H) may not be exceeded!



- The device is only designed for the use specified in this documentation.
- Every other use is not authorized and is forbidden!
- All relevant safety regulations, corresponding legal regulations, especially regulations of the declaration of conformity, and additional local health and safety regulations have to be observed.



Prior to every operation the user **must** ensure that:

- The equipment is suited to the intended operation, the functioning and the working condition of the equipment is examined, and the load is suitable to be handled.

*Any doubts about instructions should be raised with the manufacturer prior to use.*



#### NOT ALLOWED ACTIVITIES:

**Unauthorized alterations** of the device and the use of any self-made additional equipment could cause danger and are therefore **forbidden!**

Never exceed the **carrying capacity** and the **nominal width/nominal size** of the device.

#### **All unauthorized transportations with the device are not allowed:**

- Transportation of people and animals.
- Transportation of other loads and materials than described in this manual.
- Never suspend any goods with ropes, chains or similar at the device.

### 3.2 Survey and construction

#### SDH-H

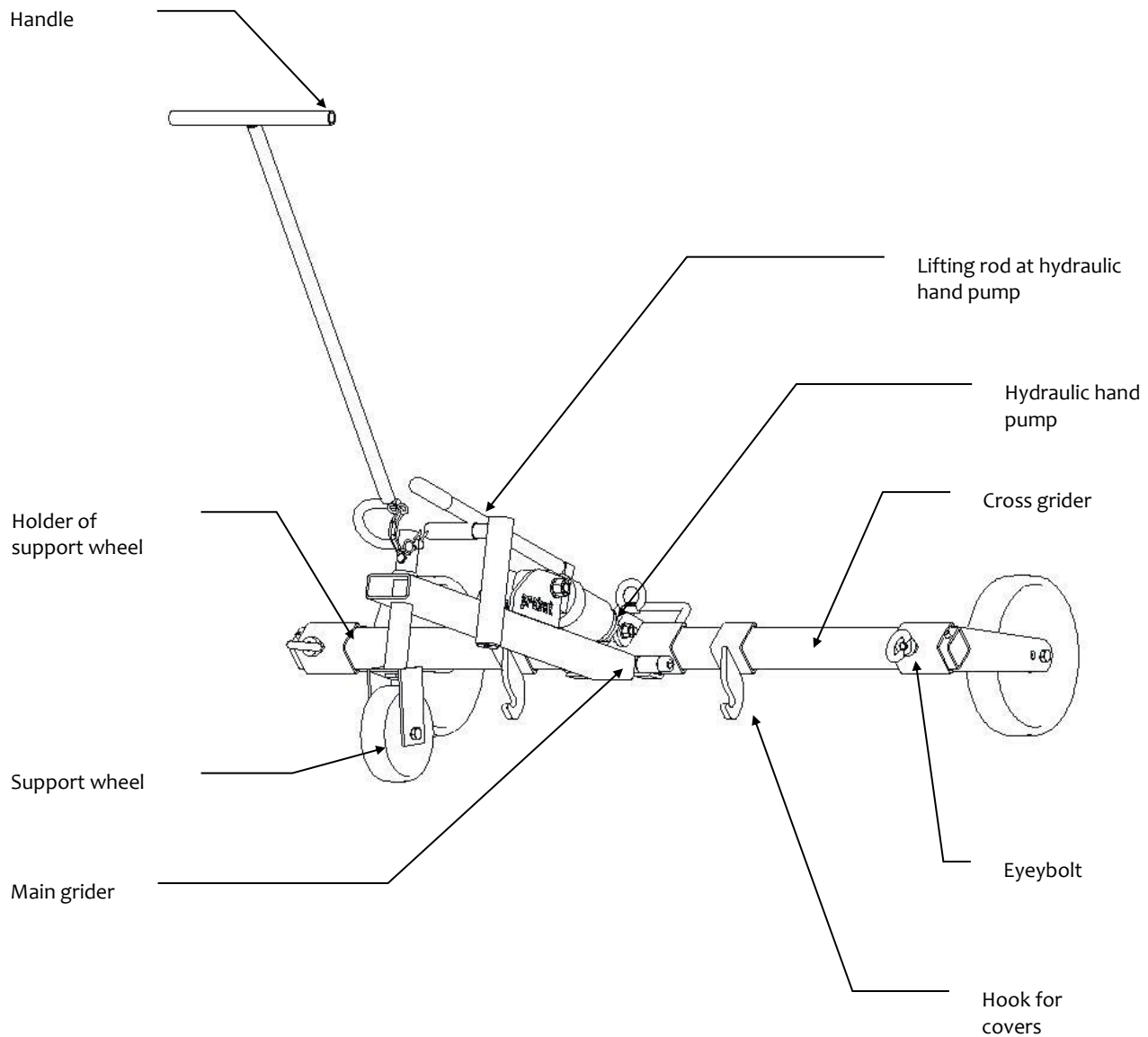

### 3.3 Technical Data

Type	Max. wheel span	Hook centres min./max.	Lifting height	Pulling force	Dead weight
SDH-H-15	1,050 mm (41")	260/950 mm (10¼/37½")	310 mm (12¼")	1,500 kg (3,300 lbs)	36 (80 lbs)



### 3.4 Accessories

Key A

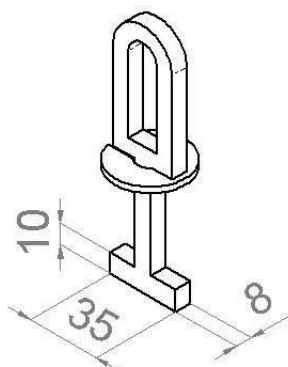

Key B

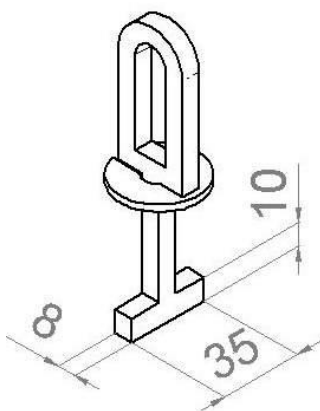

Key C

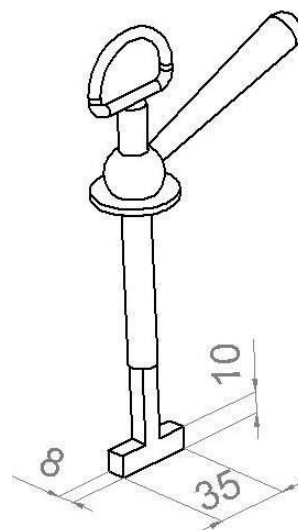

Spreader bar „small“

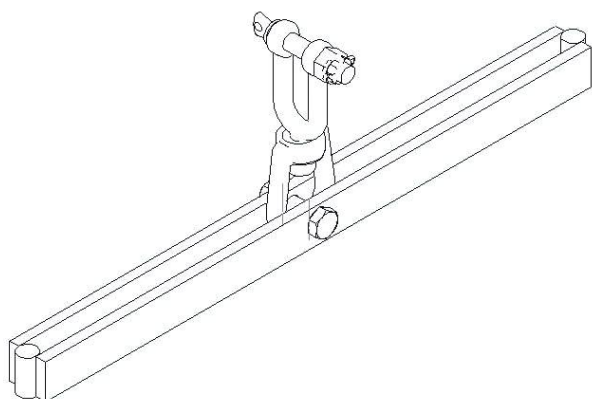

Spreader bar „large“

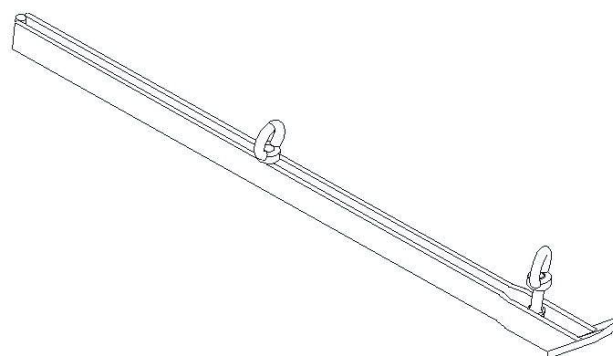

Type	Description	Order-No.
Keys and spreader bars	Key A	44800019
	Key B	44800020
	Key C	44800017
	Spreader bar „small“	44800008
	Spreader bar „large“	44800018
Set of keys and spreader bars UK	2 keys A, 2 keys B, 4 keys C, 1 Spreader bar „small“, 2 Spreader bars „large“	54800004
Tool and Equipment Box WZK	Size 1.200 x 550 x 630 mm to stow the complete device(SDH-H) including all accessories.	42200107



There are always two keys necessary for lifting.

## 4 Operation

### 4.1 Attaching Variants

Depending upon form, kind and execution of the covers, the suitable hooks (A or B), and/or spreader bars (variant I or II) must be selected.

#### HOOK A

Hook A (2x44800019)

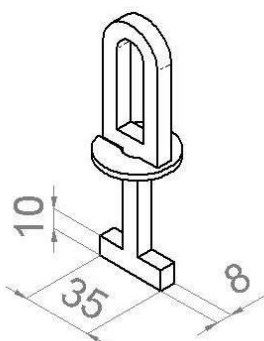

#### HOOK B

Hook B (2x44800020)

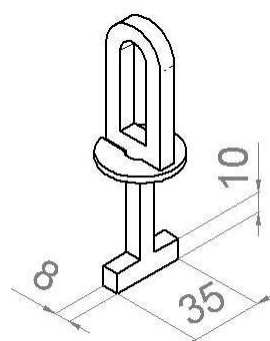

#### VARIANT I

Spreader bar „small“ (44800008)

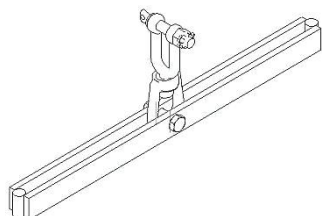

Hook C (4x44800017)

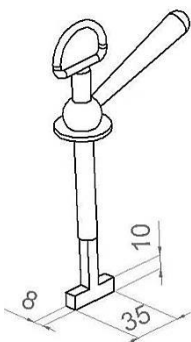

Spreader bar „small“ (44800008) + Hook C (44800017)

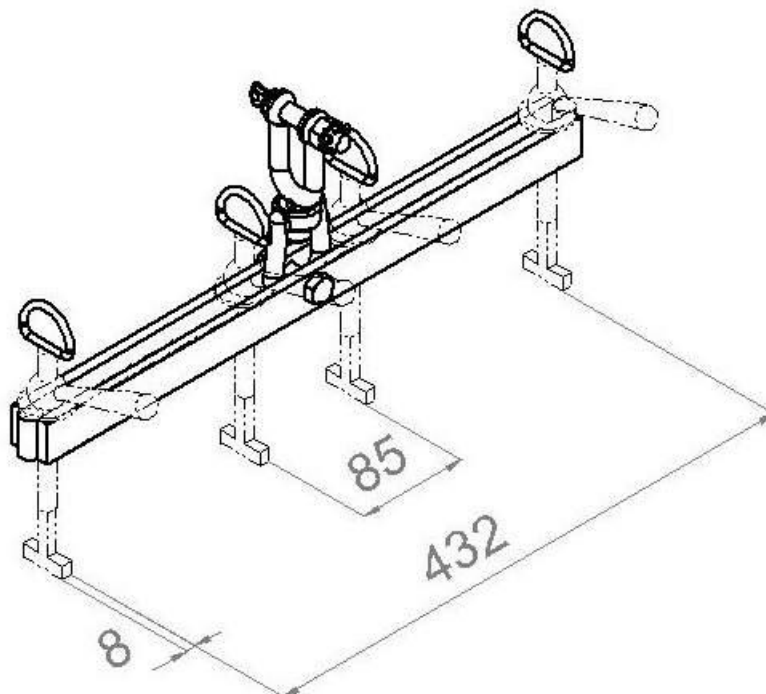

**VARIANT II**

Spreader bar „large“ (2x44800018)

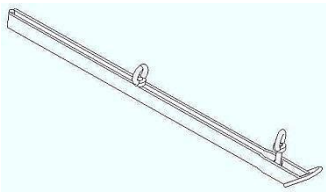

+ ➔

Hook C (4x44800017)

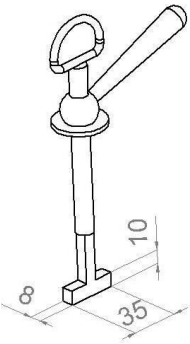

Spreader bar „large“ (44800017) + Hook C (44800017)

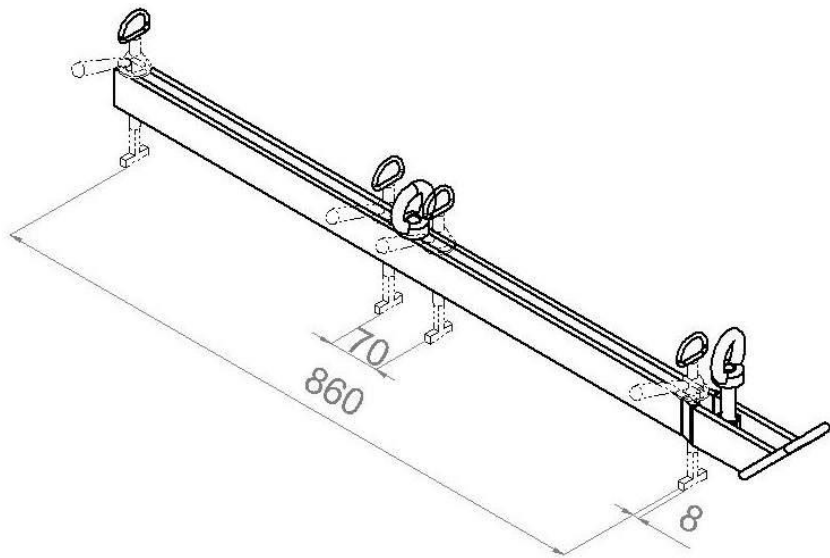

## 4.2 Device Operating

- Prepare spreader bars and/or hooks suitably the cover, which is to be raised.

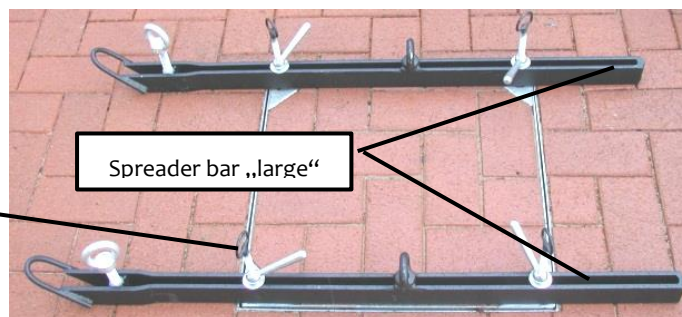
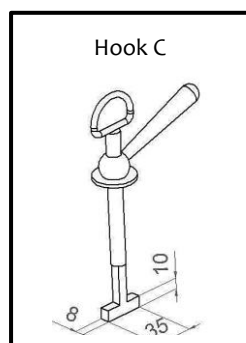

- Drive with the device (SDH-H) over the cover and hang up the hooks (A or B) into the hooks at the device (SDH-H).

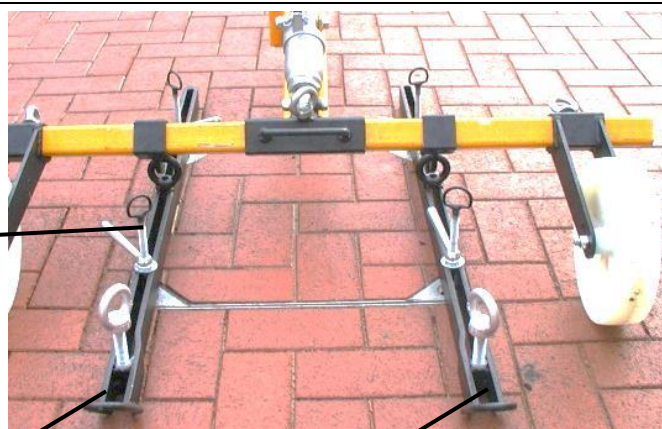
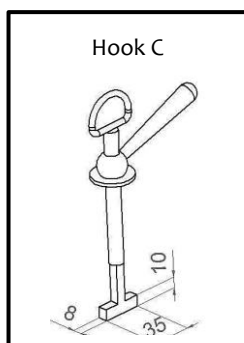

- Use the lifting rod at hydraulic hand pump to pump the device highly



**ATTENTION:** Bring hands and feet out of the danger area of the device (SDH-H)!

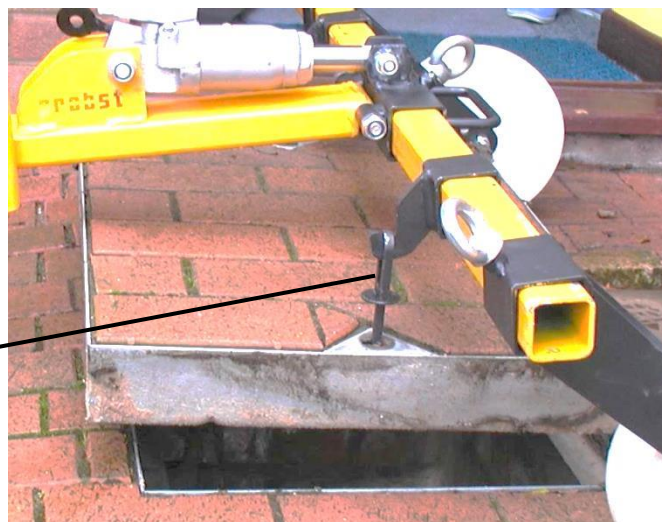
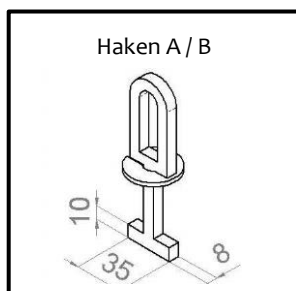



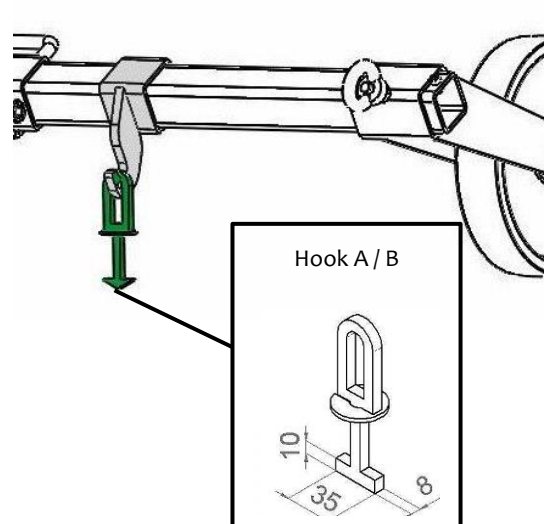
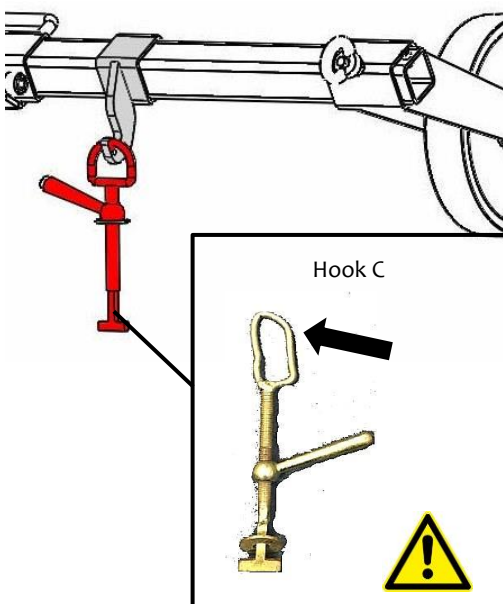
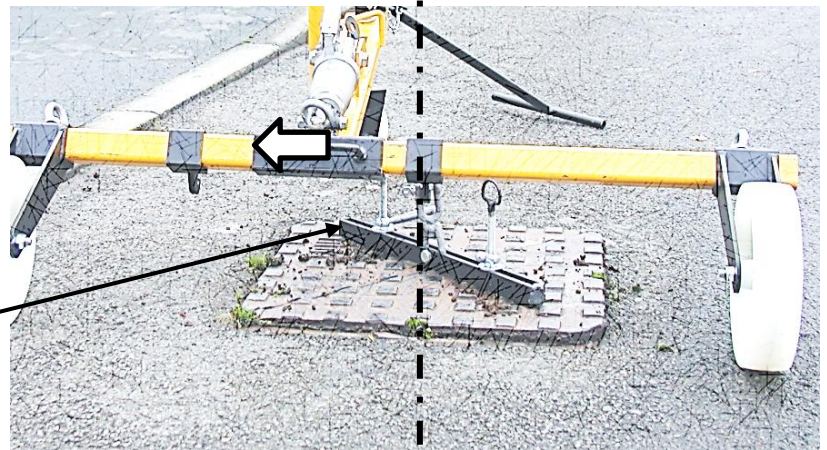
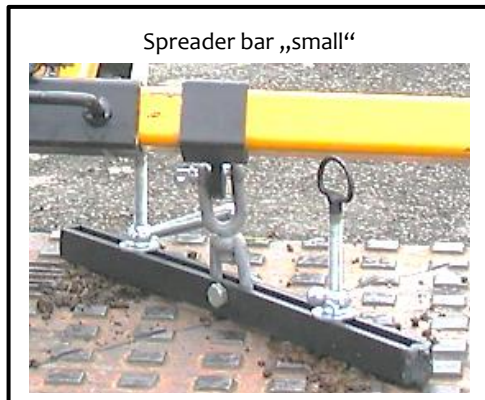

- The device (SDH-H) can now be driven with the lifted cover carefully to the place of destination.
- In order to discharge cover again, rotate by hand the lifting rod at hydraulic hand.



**ATTENTION:** Bring hands and feet out of the danger area of the device (SDH-H)!

## 5 Maintenance and care

### 5.1 Maintenance



To ensure the correct function, safety and service life of the device the following points must be executed in the maintenance interval.

Used **only original spare parts**, otherwise the warranty expires.



**All operations may only be made in closed state of the device!**

#### 5.1.1 Mechanical

SERVICE INTERVAL	Maintenance work
<b>First inspection after 25 operating hours</b>	<ul style="list-style-type: none"> <li>Control and tighten all screws and connections. (The implementation is only allowed by an expert).</li> </ul>
<b>All 50 operating hours</b>	<ul style="list-style-type: none"> <li>Tighten all screws and connections (take care that the tightening torques according to the property class of the screws are observed).</li> <li>Check all existing safety elements (such as linchpins) for perfect function and replace defective safety elements. → 1)</li> <li>Check all joints, bolts, guidance's and gears for correct function, if necessary adjust or replace it.</li> <li>Check all grippers (if available) for signs of wear.</li> <li>Grease all slidings (if available) when the device is in opened position with a spatula.</li> <li>Grease all grease nipples (if available) with a grease gun.</li> </ul>
<b>Minimum 1x per year</b> (at rough conditions shorten the interval)	<ul style="list-style-type: none"> <li>Check of all the suspension parts, bolts and straps. Check for corrosion and safety by an expert.</li> </ul>

1)

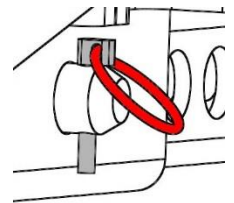
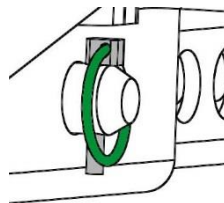

### 5.2 Repairs



**Only persons with the appropriate knowledge and ability are allowed to repair the device.**  
**Before the device is used again, it has to be checked by an expert.**

### 5.3 Safety procedures

- It is the contractor's responsibility to ensure that the device is checked by an expert in periods of max. 1 year and all recognized errors are removed (→ see BGR 500).
- The corresponding legal regulations and the regulations of the declaration of conformity have to be observed!
- We recommend that after checking the device, the badge "Safety checked" is put on the device. (Order-No.: 2904.0056+inspection sticker with date).
- You can receive these badges from us.



**The check by an expert must be proved!**

Device	Year	Date	Expert	Company

## 5.4 Hints to the type plate



Type, serial-number and production year are very important for the identification of your device. If you need information to spare-parts, warranty or other specific details please refer to this information.

The maximum carrying capacity/working load limit (WLL) is the maximum load which can be handled with the device. Do not exceed this carrying capacity/working load limit (WLL).

If you use the device in combination with other lifting equipment (Crane, chain hoist, forklift truck, excavator) consider the deadweight of the device.

Example:



## 5.5 Hints to the renting/leasing of PROBST devices



With every renting/leasing of PROBST devices the original operating instructions must be included unconditionally (in deviation of the users country's language, the respective translations of the original operating instructions must be delivered additionally)!



# Proof of maintenance

Warranty claim for this machine only apply for performance of the mandatory maintenance works (by an authorised specialist workshop)! After each completed performance of a maintenance interval the included form must be fill out, stamped, signed and send back to us immediately <sup>1)</sup>.

1) via e-mail to service@probst-handling.de / via fax or post

Operator: \_\_\_\_\_

Device type: \_\_\_\_\_

Device-No.: \_\_\_\_\_

Article -No.: \_\_\_\_\_

Year of make: \_\_\_\_\_

## First inspection after 25 operating hours

Date:	Maintenance work:	Inspection by company:
		Company stamp
		.....
		Name Signature

## All 50 operating hours

Date:	Maintenance work:	Inspection by company:
		Company stamp
		.....
		Name Signature
		Company stamp
		.....
		Name Signature
		Company stamp
		.....
		Name Signature

## Minimum 1x per year

Date:	Maintenance work:	Inspection by company:
		Company stamp
		.....
		Name Signature
		Company stamp
		.....
		Name Signature



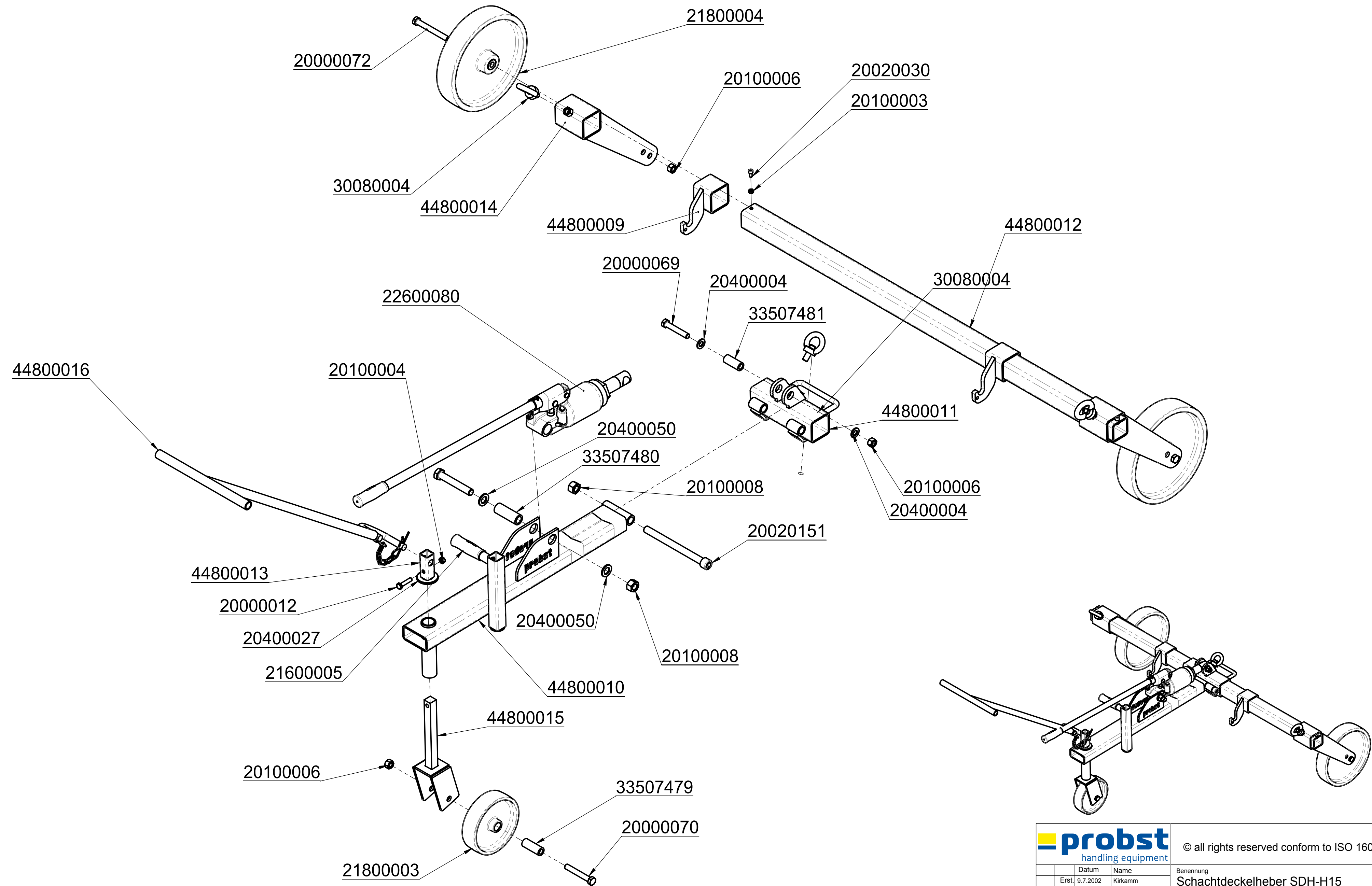

			© all rights reserved conform to ISO 16016	
	Datum	Name	Benennung Schachtdeckelheber SDH-H15	
	Erst. 9.7.2002	Kirkamm		
	Gepr. 25.1.2017	R. Wolff		
			Artikelnummer/Zeichnungsnummer	
2			E54800002	
1			Blatt 1 von 1	
Zust.	Urspr.		Ers. f.	Ers. d.



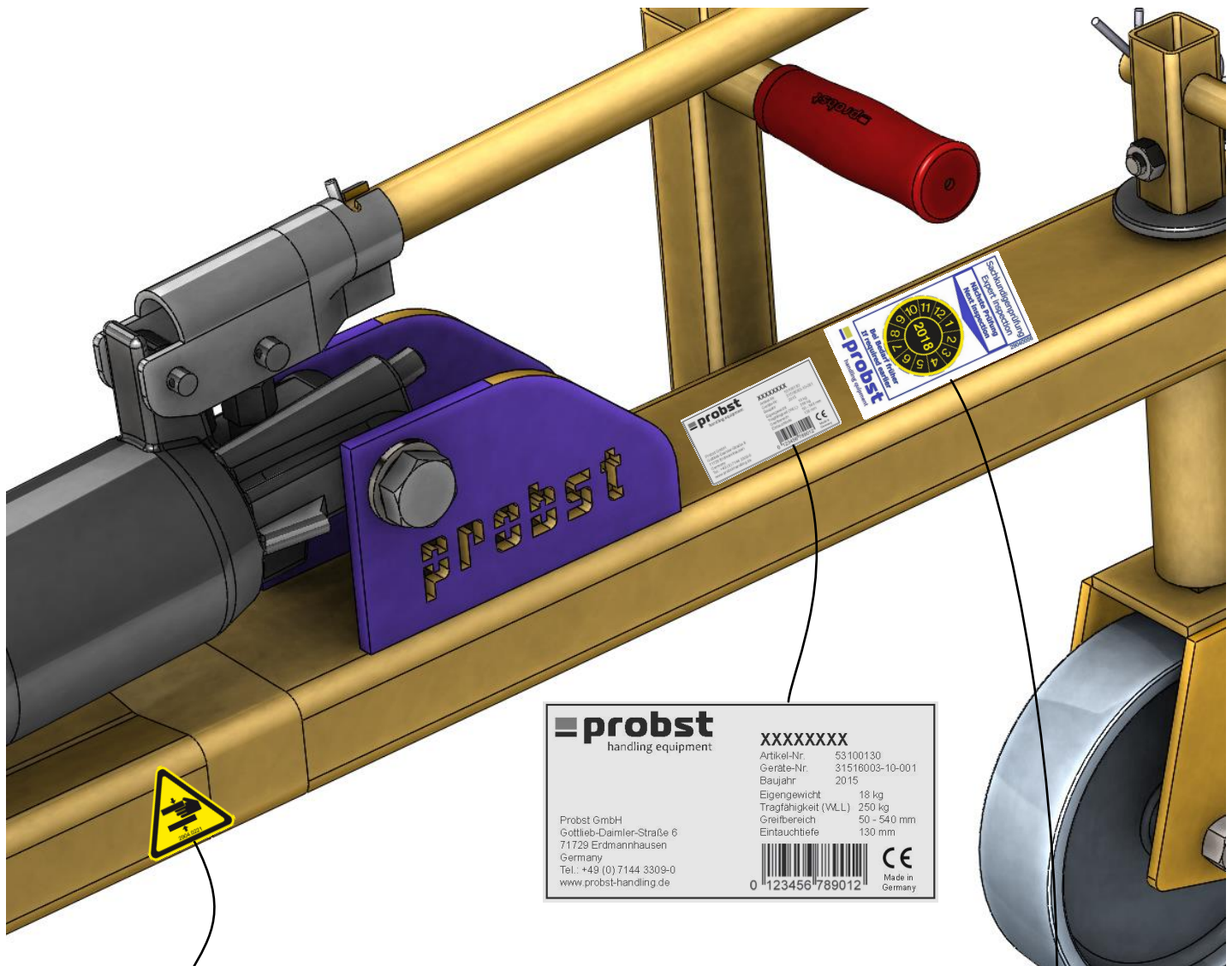

29040221  
Auf beiden Seiten/  
On both sides



29040665



29040056

